

RF CABINET KIT

46-301924G1

MR1

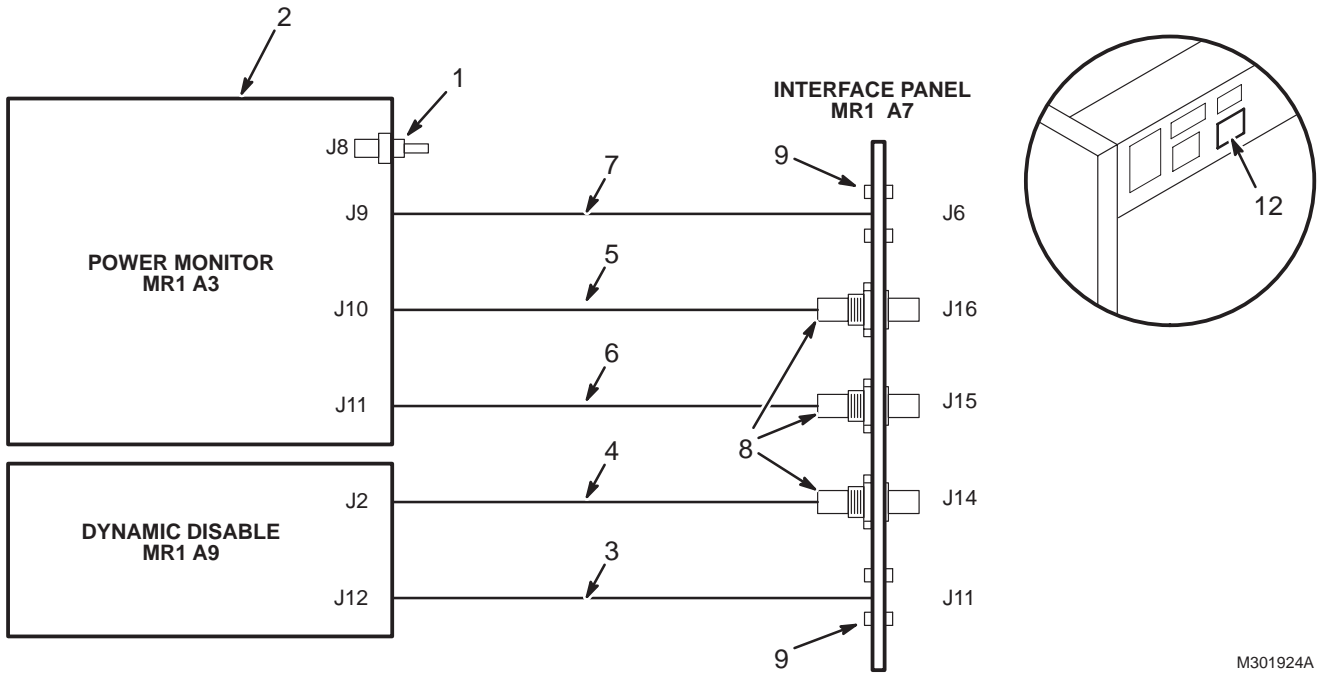

M301924A

RF CABINET KIT

46-301924G2

MR1

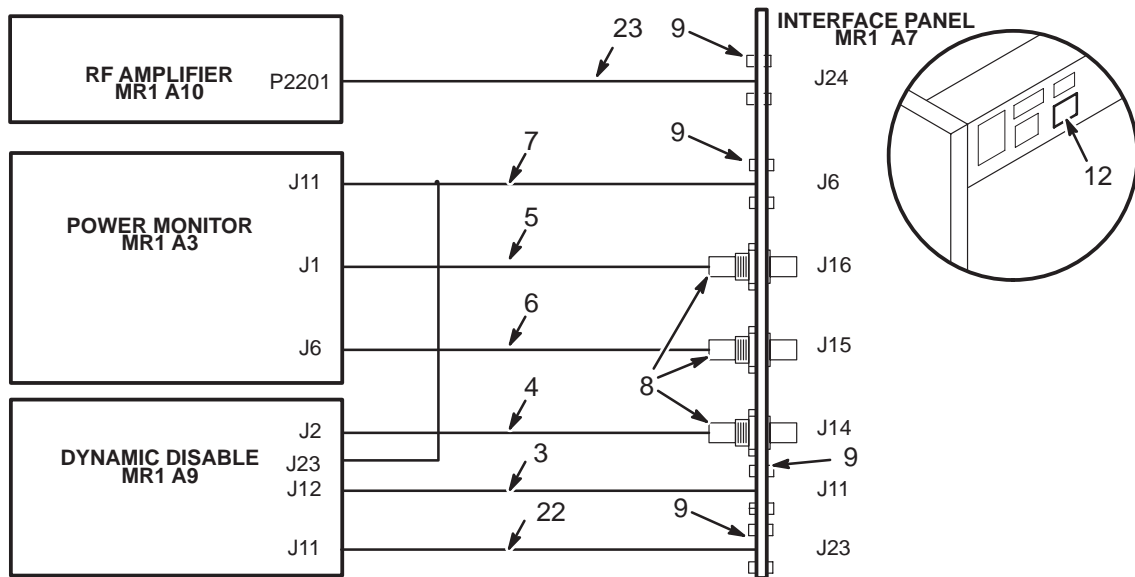

RF CAB KIT (FF) 46-301924G1 REV AD PART OF M1040FF (PG 1)

Item	Part Number	FRU	Name	Quantity	Description (Remarks)
1	46-208697P47	2	BUSHING	1	HEYCO PART NO.1200 SR-6N3-4 BLACK
2	46-307761G1	N	MONITOR ASM	1	POWER MONITOR CHASSIS W/SPECTRO I/F (SEE PAGE 21) Obsoleted W/ FMI 60420
3	46-243775G747	2	CABLE	1	MR1-A9-J12 TO MR1-A7-J11
4	46-243775G748	2	CABLE	1	MR1-A9-J2 TO MR1-A7-J14
5	46-243775G744	2	CABLE	1	MR1-A3-J10 TO MR1-A7-J16
6	46-243775G745	2	CABLE	1	MR1-A3-J11 TO MR1-A7-J15
7	46-243775G746	2	CABLE	1	MR1-A3-J9 TO MR1-A7-J6
8	46-230194P1	2	CONNECTOR	3	50 OHM, ISOLATED BNC COAXIAL ADAPTOR (N/A w/FMI 60420)
9	46-265067P1	2	CABLE MOUNT	4	I/F PANEL CABLE INTERCONNECT
13	46-170015P10	2	SCR,SEMS	4	00006-32 X 0.250 LG BIND HD STL EXT
14	46-170012P36	2	NUT,LOCK	8	6-32 HEX 5/16 NUT THK 7/64
15	46-221417P1	2	SCREWLOCK	1	FEMALE SCREWLOCKS FOR HD CONNECTORS.

RF CAB KIT (FK) 46-301924G2 REV 1 PART OF M1040FK (PG 1)

Item	Part Number	FRU	Name	Quantity	Description (Remarks)
3	46-243775G747	2	CABLE	1	MR1-A9-J12 TO MR1-A7-J11
4	46-243775G748	2	CABLE	1	MR1-A9-J2 TO MR1-A7-J14
7	2101659	2	CABLE ASM	1	MR1-A3-J11 TO MR1-A7-J6 & MR1-A9-J23
8	46-230194P1	2	CONNECTOR	3	50 OHM, ISOLATED BNC COAXIAL ADAPTOR (N/A w/FMI 60420)
9	46-265067P1	2	CABLE MOUNT	8	I/F PANEL CABLE INTERCONNECT
22	46-243775G844	2	CABLE	1	MR1-A9-J11 TO MR1-A7-J23
23	46-243775G843	2	CABLE	1	MR1-A10-P2201 TO MR1-A7-J24
24	46-208758P5	2	STRAP	20	13.38"X .301" SELF-LOCKING CABLE TIE
25	2104698	1	DETECTOR	2	SPECTROSCOPY DETECTOR W/BNC CABLES
26	2110643	1	FIRMWARE	1	FIRMWARE KIT FOR 5.4 1.5T SPECTROSCOPY

4.X TO 5.X RF CAB UPGRADE 46-317905G1 REV 3

Item	Part Number	FRU	Name	Quantity	Description (Remarks)
2	46-243775G844	2	CABLE	1	MR1-A9-J11 TO MR1-A7-J23
3	46-243775G843	2	CABLE	1	MR1-A10-P2201 TO MR1-A7-J24
4	46-208758P5	2	STRAP	20	13.38"X .301" SELF-LOCKING CABLE TIE
5	46-265067P1	2	CABLE MOUNT	4	I/F PANEL CABLE INTERCONNECT
9	46-221856P13	2	TAPE	1	WIDTH 0.75 THK .007 COLOR-BLUE
10	46-221856P14	2	TAPE	AR	WIDTH 0.75 THK .007 COLOR-GREEN

POWER MONITOR CHASSIS W/SPECTRO I/F (FF) 46-307761G1

MR1 A3

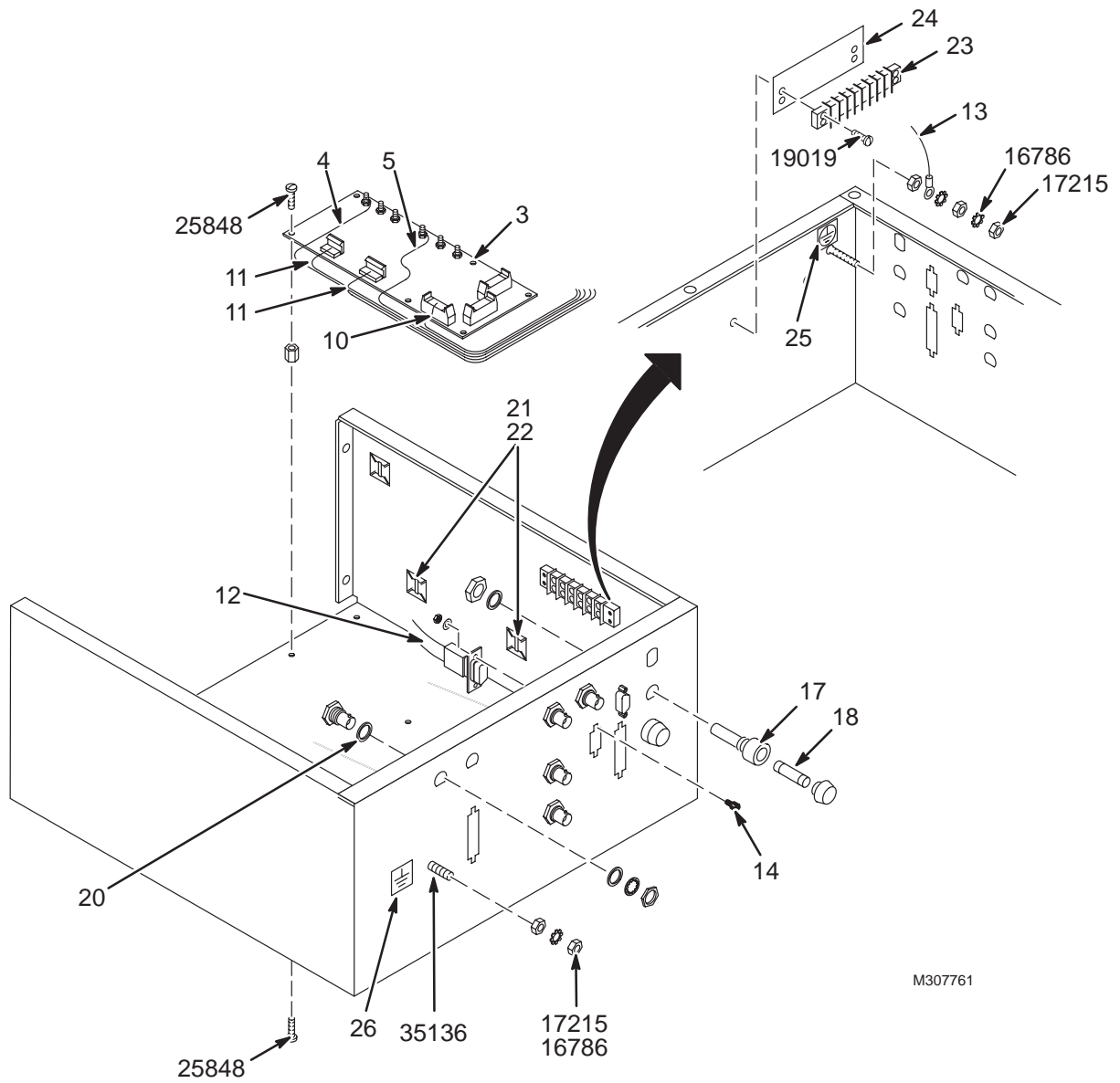

MONITOR ASM (FF) 46-307761G1 REV 0 PART OF RF CAB KIT (PG 20)

Item	Part Number	FRU	Name	Quantity	Description (Remarks)
3	46-264820G1	1	CIRCUIT BD	1	POWER MONITOR I/F BOARD (MR1 A3 A7) Obsoleted by FMI 60420
4	46-301909P1	2	CABLE ASM.	1	A4J6 TO A5J10, 26" RG174/U W/SMB Obsoleted by FMI 60420
5	46-301909P2	2	CABLE ASM.	1	A3J6 TO A5J6, 14" RG174/U W/SMB Obsoleted by FMI 60420
6	46-301910P1	2	CABLE ASM.	1	A5J9 TO J2, 28" RG174/U W/SMB & BNC
7	46-301910P2	2	CABLE ASM.	1	A5J8 TO J11, 22" RG174U W/SMB & BNC
8	46-301910P3	2	CABLE ASM.	1	A5J5 TO J6, 20" RG174/U W/SMB & BNC
9	46-301910P4	2	CABLE ASM.	1	A5J4 TO J10, 20" RG174U W/SMB & BNC
10	46-244890P126	2	RIBB.CBL.ASM	1	NO. OF COND. 09, LGTH. 14.00 Obsoleted by FMI 60420
11	46-301931G1	2	HARNESS	1	POWER MONITOR SPECTROSCOPY MODIFY Obsoleted by FMI 60420
12	46-244890P127	2	RIBB.CBL.ASM	2	NO. OF COND. 09, LGTH 14.00 Obsoleted by FMI 60420
13	46-282307G1	2	LEAD DATA	1	SET OF 3 FUSE & GROUND CONNECT WIRES
14	46-221417P1	2	SCREWLOCK	2	FEMALE SCREWLOCKS FOR HD CONNECTORS
17	46-315759P1	2	FUSE HOLDER	2	FIG.B 3AG QUICK-CONN TABS UL/CSA
18	46-170021P51	2	FUSE	2	002.000A 0250V 3AG; FAST UL/C
20	46-221313P1	2	BUSHING	4	INSULATING BUSHING FOR BULKHEAD JACK
21	46-208747P1	2	MOUNT	3	CABLE TIE,ADH.BACKED
22	46-208758P1	2	STRAP	3	3.62" X .094" CABLE TIE
23	46-221880P8	2	TERM. STRIP	1	08 TERMINALS 20 AMP 2500 VOLTS
24	514A350P294	2	MARKER STR	1	8 POSITION MARKER STRIP
25	46-271110P1	2	LABEL	1	PROTECTIVE EARTH (GROUND)
26	46-271110P2	2	LABEL	1	EARTH (GROUND)
16786	46-208935P7	2	NUT,HEX,MS	5	00010-32 .375 HEX X .125 THK BR
17215	46-208599P4	2	WASHER,LOCK	3	SCREW SIZE #10 EXTERNAL TOOTH
19019	46-170015P27	2	SCR,SEMS	2	00006-32 X 0.500 LG BIND HD STL EXT
25848	46-208560P68	2	SCREW,MACH	12	006-32 X 0.250 LG BIND HD STL F70B5A
35136	46-170015P62	2	SCR,SEMS	1	00010-32 X 0.750 LG BIND HD STL EXT
FMI 60420 HARDWARE COMPONENTS					
10	46-244890P152	2	RIBB.CBL.ASM	1	NO. OF COND. 09, LGTH. 18.00 Installed by FMI 60420
12	46-244890P153	2	RIBB.CBL.ASM	2	NO. OF COND. 09, LGTH 18.00 Installed by FMI 60420