

## SECTION MAG – MAGNET ELECTRONICS

REV 2

MAGNET ELECTRONICS ITEMS

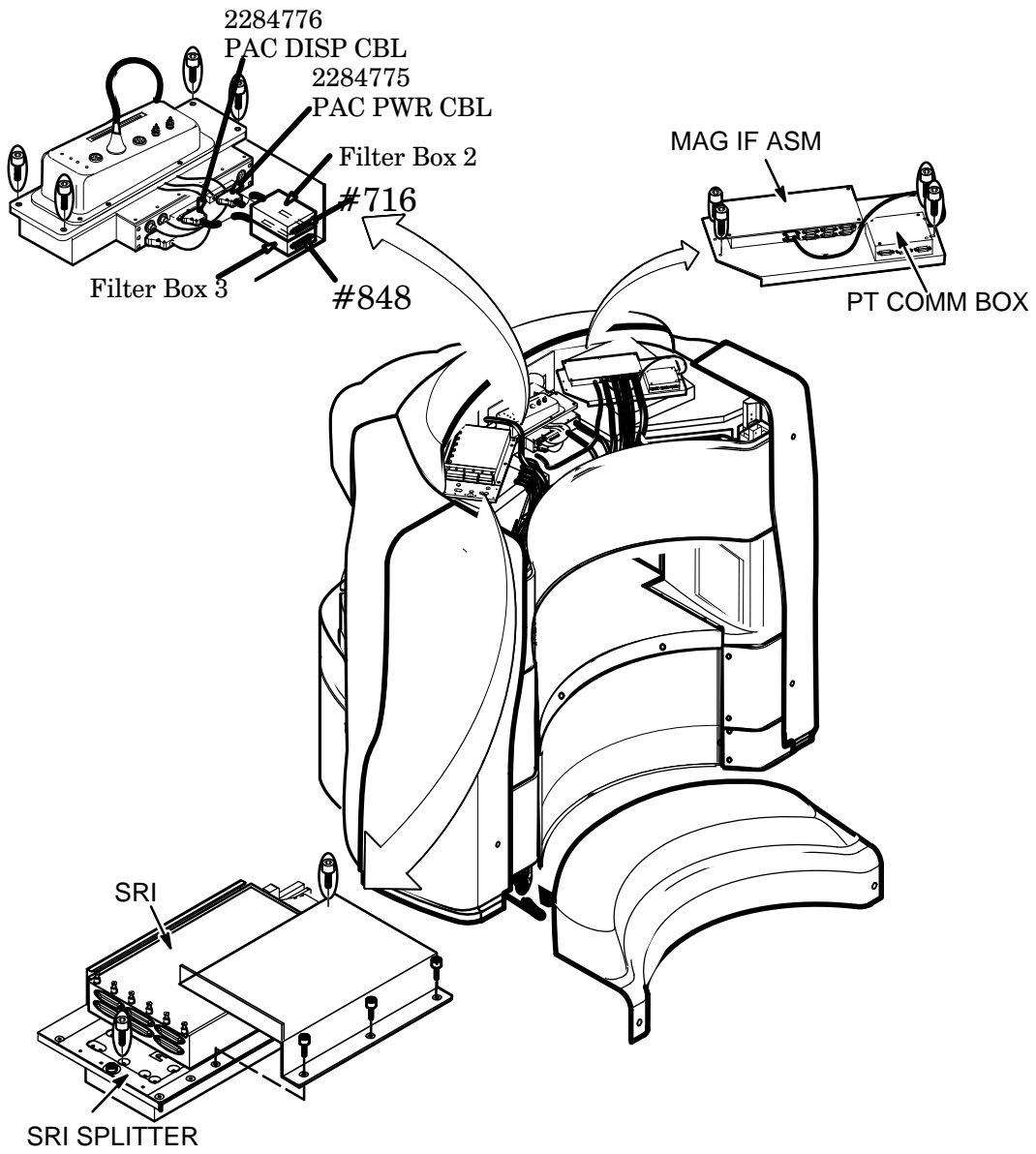

REV 2

**MAGNET ELECTRONICS ITEMS**

Item	Part Number	FRU	Name	Quantity	Description (Remarks)
1	2284837	N	PAC FLT	1	P9423ST MFO PAC FILTER ASSY
2	2284838	1	CABLE	1	P9423SU CABLE ASSY
3	2282881	N	MAGNET ELEC	1	P9420BH 0.35T MAGNET ELECTRONICS
4	46-317185G1	2	PT COMM BOX	1	PATIENT COMMUNICATION BOX
5	2122268-7	1	PAC-II ASM	1	MFO PAC W/LONGER PPG CABLE ASM
6	46-287370G7	2	SRI ASM	1	SCAN ROOM INTERFACE (SRI)
7	2259621	2	SRI SPLITTER	1	SRI SPLITTER ASM
8A	2254366-2	1	MAG IF ASM	1	MAGNET I/F ASM W/NEW FIRMWARE
8B	2254366	1	MAG IF ASM	ALT	MAGNET INTERFACE ASSEMBLY
9	2227142-2	N	RMT PAC IF	1	MRHFO REMOTE PAC INTERFAC
10	46-317903G5	1	CABLE F. O.	1	FIBER OPTIC PPG CABLE ASM - 253" LG

**P9423ST MFO PAC FILTER ASSY 2284837 REV 001**

Item	Part Number	FRU	Name	Quantity	Description (Remarks)
1	2225039	1	FLT BOX2	1	P9363RR FILTER BOX2 ASSY
2	2228335	1	FLT BOX3	1	P9363RU FILTER BOX3 ASSY
3	2284775	1	CABLE	1	P9423SV CABLE ASSY
4	2284776	1	CABLE	1	P9423SW CABLE ASSY

**0.35T MAGNET ELECTRONICS 2282881 REV 000**

Item	Part Number	FRU	Name	Quantity	Description (Remarks)
1	2285500	N	DISPLAY ASM	1	P9423WA MFO DISPLAY
2	2285501	N	PCM ASM	1	P9423WB MFO PCM

**P9423WA MFO DISPLAY 2285500 REV 000**

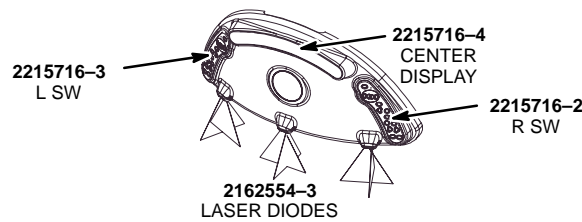

**P9423WA MFO DISPLAY 2285500 REV 000**

Item	Part Number	FRU	Name	Quantity	Description (Remarks)
1	2215716-2	1	R SW	1	MAESTRO MAGNET HOUSING RH DISPLAY / DISPLAY
2	2215716-3	1	L SW	1	MAESTRO MAGNET HOUSING LH DISPLAY / DISPLAY
3	2215716-4	1	C DISPLAY	1	MAESTRO MAGNET HOUSING CNTR DISPLAY / DISPLAY
4	2221465-2	N	MODULE	3	MAESTRO ALIGNMENT LIGHT MODULE_TOP
5	2162554-3	1	LASER	6	LASER FOR CONQUEST MAG FRT COVER AS
6	2269030-12	N	GE LOGO DECAL	1	ENCAPSULATED GE LOGO

REV 2

PCM RELATED ITEMS

REV 000

Item	Part Number	FRU	Name	Quantity	Description (Remarks)
1	2248337	N	AIR NOZZLE		
2	2248340	N	BEZEL		
3	2248341	N	PART		
4	2236511	N	PART		
5	2255647	N	PART		
6	2255646	N	PART		
7	2255648	N	PART		
8	2259693	N	PART		
9	2259696	N	PART		
10	46-221523P26	1	VENT PLUG		
11	46-221773P2	1	SPEAKER		
12	46-208560P111	N	SCREW		
13	46-136374P65	N	RING OLD		
14	46-317252G4	1	CABLE		
15	46-317157G6	1	CABLE		
16	46-317157G3	1	CABLE		
17	46-317134P1	1	MIKE HOUSING		
18	46-317135P1	1	CABLE CLAMP		

PT COMM BOX

46-317185BOM1

REV 004

Item	Part Number	FRU	Name	Quantity	Description (Remarks)
2	46-317137P1	2	PT COMM BOX	1	PATIENT COMMUNICATION BOX – EMPTY
6A	2204384	1	RMT INTCOM	1	REMOTE INTERCOM BOARD

SCAN ROOM INTERFACE (SRI)46-287370BOM7

REV

001

Item	Part Number	FRU	Name	Quantity	Description (Remarks)
3B	46-288016G8	1	SRI BD	ALT	SCAN ROOM INTERFACE BOARD

RMT PAC INTERFACE

2227142-2

REV 001

Item	Part Number	FRU	Name	Quantity	Description (Remarks)
2	2221024	2	CABLE	1	WIDE OPEN PAC HANGER CABLE INTERFAC
3	2222710	2	CABLE	2	WIDE OPEN PAC INTERFACE CLAMP BRCKT
4	2219096	2	CABLE	1	ECG EXTENSION CABLE_MG2A11-ECG
5	2219097	2	CABLE	1	EXTEN. CABLE_MG2A11 PERIPHERAL PULS
6	46-265651P1	2	COUPLING	2	COUPLING, PANEL MTG / COLDER PROD CO. #PMC 16-02 /
7	2221023	2	HANGER BAR	2	WIDE OPEN PAC HANGER BAR
9	46-328420P502	2	SCREW HEAD	4	SCREW BUTTON HEAD 3 MM 8 MM
12	46-265652P1	2	INSERT	2	COUPLING INSERT / COLDER PROD CO. #PMC 22-02 /
13	2109874-17	2	SCREW	1	SCREW COUNTERSUNK HEA 4 MM 40 MM
14	2238216-2	2	SCREW	4	SCREW HEXAGON SOCKET 6 MM 60 MM
15	2221024-2	2	CABLE	1	MRHFO PAC HANGER CABLE INTERFACE

REV 2

**Revision History**

<b>Rev</b>	<b>Date</b>	<b>Author</b>	<b>Primary reasons for change</b>
0	May 23, 2001	M.Ikeda	Initial release
1	Jan. 31, 2002	M.Ikeda	Added Renewal Parts for MFO2
2	Jul. 4, 2002	M.Ikeda	Updated PAC part number